



## THE SCOTTSDALE RESORT & SPA

EVERY GREAT EVENT BEGINS WITH THE PERFECT SETTING—AND AT THE SCOTTSDALE HOTEL RESORT & SPA, WE OFFER A VARIETY OF SPACES WHERE STORIES UNFOLD, MEMORIES ARE MADE, AND CONNECTIONS ARE CELEBRATED.



### MEETING & FUNCTION SPACE

- 45,000 Square Feet of Flexible Interior Space
- 40,000 Square Feet of Exterior Function Space Full Service & Experienced Conference & Planning Department
- Complete Meeting Package & Modified Packages
- 2 Full Serve Break Stations
- Full Service & on-site Audio Visual Department
- Ergonomic Chairs Available for All Meetings
- On-Site Transportation.



### FACILITIES / RECREATION / SERVICES

- 2 Heated Swimming Pools
- Cabana Rentals
- Adjacent McCormick Ranch Golf Club with 36 Holes
- On-site UPS Service
- Dry Cleaning
- Fitness Center with Life Fitness™ Cardio Machines
- + Peloton™ Bikes
- Luna Spa
- Self-Parking & Valet Parking



### DINING & ENTERTAINMENT

- La Fogata Kitchen and Bar
- Barnaby's Café & Wine Bar
- The Madam Cocktail Bar
- Twisted Vine Poolside Bar & Grill
- The Social Boardroom - pool table, golf simulator and shuffle board

# GROUND LEVEL

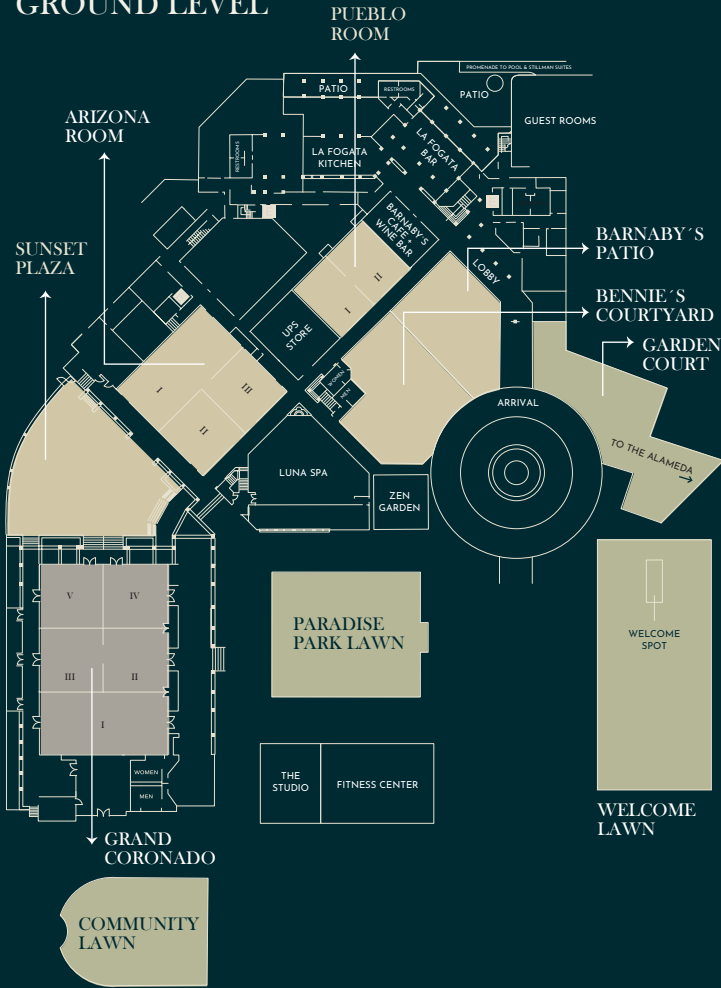

LOCATION	DIMENSIONS	SQ. FEET	THEATRE	SCHOOLROOM	U-SHAPE	BANQUET
<b>GRAND CORONADO</b> Ceiling Height - 22' Soffit 20'	<b>120x 80</b>	<b>10,000</b>	<b>1,000</b>	<b>640</b>	<b>N/A</b>	<b>700</b>
I	40x80	3,200	324	144	76	210
II	40x40	1,600	144	70	36	90
III	40x40	1,600	144	70	36	90
IV	40x40	1,600	144	77	36	90
V	40x40	1,600	144	70	36	90
<b>ARIZONA ROOM</b>	<b>78x78</b>	<b>6,084</b>	<b>660</b>	<b>308</b>	<b>88</b>	<b>420</b>
I	78x39	3,042	254	132	80	180
II	39x39	1,520	120	70	36	90
III	39x39	1,521	120	77	36	90
II & III	78x39	3,042	248	132	80	180
<b>PUEBLO ROOM</b>	<b>89x41</b>	<b>2,296</b>	<b>432</b>	<b>240</b>	<b>84</b>	<b>270</b>
I	31x41	1,271	108	64	30	80
II	25x41	1,025	108	64	30	80
<b>BENNIE'S COURTYARD</b>	-	-	-	-	-	<b>180</b>
<b>SUNSET PLAZA</b>	-	-	-	-	-	<b>350</b>
<b>MCCORMICK POOL</b>	-	-	-	-	-	-
<b>STILLMAN POOL</b>	-	-	-	-	-	<b>330</b>
<b>THE ALAMEDA</b>	-	-	-	-	-	<b>600</b>
<b>PARADISE PARK LAWN</b>	-	-	-	-	-	<b>500</b>
<b>COMMUNITY LAWN</b>	-	-	-	-	-	<b>250</b>
<b>GARDEN COURT</b>	-	-	-	-	-	<b>60</b>
<b>WELCOME LAWN</b>	-	-	-	-	-	<b>30</b>
<b>MCCORMICK COURT</b>	-	-	-	-	-	<b>110</b>

# UPPER LEVEL

LOCATION	DIMENSIONS	SQ. FEET	THEATRE	SCHOOLROOM	U-SHAPE	BANQUET
<b>MARICOPA ROOM</b>	<b>178x78</b>	<b>6,084</b>	<b>1660</b>	<b>308</b>	<b>88</b>	<b>420</b>
I	78x39	3,042	264	132	80	180
II	39x39	1,521	120	77	36	90
III	39x39	1,521	120	77	36	90
II & III	78x39	3,042	248	132	80	180
<b>PAPAGO ROOM</b>	<b>66x40</b>	<b>2,640</b>	<b>220</b>	<b>144</b>	<b>52</b>	<b>190</b>
I	33x40	1,320	110	60	24	80
II	33x40	1,320	110	60	24	80
<b>APACHE ROOM</b>	<b>105x41</b>	<b>24,305</b>	<b>480</b>	<b>272</b>	<b>84</b>	<b>270</b>
I	39x41	1,599	124	64	30	90
II	39x41	1,599	124	64	30	90
III & IV	27x41	1,107	96	36	24	70
III	27x20	540	50	18	18	30
IV	27x21	567	50	18	18	30
<b>COUNCIL ROOM</b>	<b>31x21</b>	<b>651</b>	<b>48</b>	<b>30</b>	<b>20</b>	<b>40</b>
<b>TREATY</b>	<b>33x21</b>	<b>693</b>	<b>48</b>	<b>30</b>	<b>20</b>	<b>40</b>
<b>HOPI</b>	<b>21x14</b>	<b>294</b>	<b>16</b>	<b>9</b>	<b>N/A</b>	<b>10</b>
<b>SOCIAL BOARDROOM</b>	-	-	-	-	-	-
<b>VISTA VERDE</b>	-	-	-	-	-	<b>140</b>

